

EXPLODED VIEW

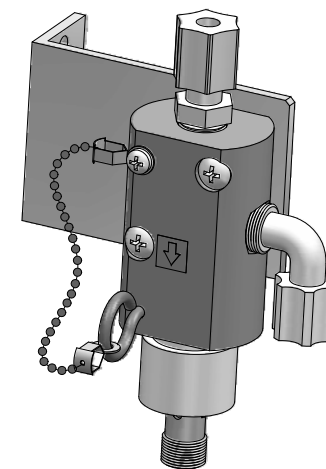

FINISHED ASSEMBLY

FINAL ASSEMBLY PART NUMBER TABLE	
MATERIAL	PART NUMBER
KYNAR	WCS
316SS	WCSSS

REV	DATE	DESCRIPTION	DWN	APVD
-	01/07/14	Initial Release	MW	DA
REVISIONS				
9	1	-	4704-0016	#6-32 Screw
8	1	-	4953-0003	1/4" Connector
7	1	-	4953-0001	1/4" Elbow
6	2	-	4704-0040	#10-32 Screw
5	1	-	5001-0004	Arrow Label
4	1	-	5008-0111	Mount Bracket
3	1	-	5205-0007	Sensor Lock Kit
2	1	-	5101-1004	Moisture Sensor
1	1	-	5101-0002	Flow Thru Body
ITEM	QTY	DWG NO.	PART NO.	DESCRIPTION

DIMENSIONS IN INCHES				
TOLERANCES				
.0 ± .015"				
.00 ± .010"				
.000 ± .005"				
FRACTIONAL ALL ± .015"				
ANGLES ± 1 30'				
UNLESS OTHERWISE SPECIFIED				
WATER CARRY OVER MOISTURE SENSOR WITH FLOW THRU ADAPTER FOR WCS & WCSSS 5200 Convaire Drive Carson City, NV 89706 PH(775)883-2500 FAX (775)883-6388				
				
DRAWN BY	M. Walsler	ECO#	DRAWING NO	
APVD BY	D. Ayers	1929	P2054	
DATE	01/07/14	SCALE	SIZE	SHEET
		1:1	D	1 OF 1